

KVT 80 ATEX

Split Cable Glands

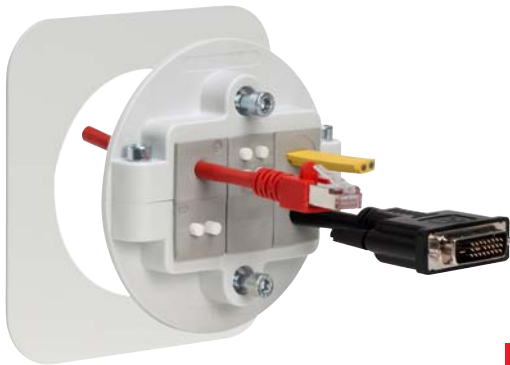

Product Description

The KVT 80 split cable glands are designed for routing and sealing pre-terminated cables.

By connecting the two half shells via attached screws, the inserts provide sufficient pressure on the routed cables. The KVT 80 can be fitted to a wall thickness from 1.5 mm to 10 mm.

Advantages

- Insertion of pre-terminated cables
- Warranty of pre-terminated cables remains
- Easy and quick retrofitting and maintenance
- High packing density, wide variety of inserts
- Quick and easy assembly from the front side

Note

When mounting the KVT 80 on sheet metal, we recommend the following torque values:
1.5 mm sheet = 1 Nm / From 2 mm sheet = 1.5 Nm

Specifications

Material	Polycarbonate (PC)
	Screws: Stainless steel
Color	<input type="checkbox"/> gray (similar RAL 7035) <input checked="" type="checkbox"/> black
Flame class	UL94-Vo, self-extinguishing
Protection class	IP54, with gasket and correct selection of cable inserts
Temperature	- 30°C to + 90°C (static)
Equipment group	II
Category	2G, 3G, 2D, 3D
Zone	1 + 21, 2+22
Test standard	EN 60079-0
Properties	Halogen free, silicone free

Accessories

KT Cable inserts, gray Page 30 - 34

Type	Order No.	Cut-out	Protection class	Inserts KT small large	PU
------	-----------	---------	------------------	-----------------------------	----

KVT 80 3 ATEX	<input type="checkbox"/> 49120	Ø 80 mm	IP54	2 1	1
	<input checked="" type="checkbox"/> 49123				
KVT 80 6 ATEX	<input type="checkbox"/> 49121	Ø 80 mm	IP54	6 -	1
	<input checked="" type="checkbox"/> 49122				

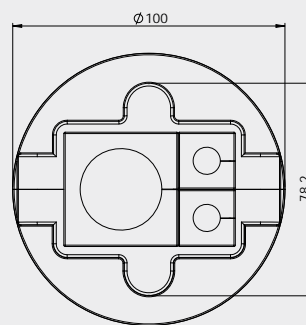

KVT 80|3 ATEX

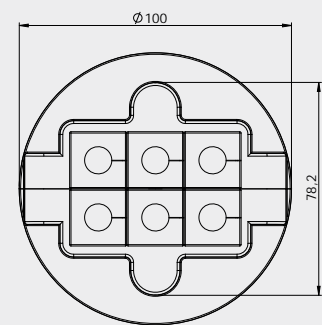

KVT 80|6 ATEX

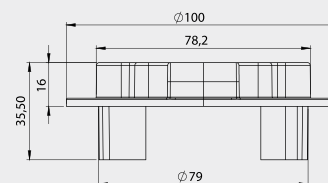

*Only valid for gray product types