

KDR-ESR

Enclosure Base Plate with Slide Frames



KDR-ESR Assembly

Product Description

The KDR-ESR is a one-piece plate to be assembled on enclosure bases. Slide frames for the KEL cable entry frames are already preassembled.

After fitting all cables into the KEL frames, they are easily and quickly inserted into the slide frames and fixed. During maintenance, the KEL frames are removed without tools from the slide frames. Due to the combination KDR-ESR and KEL cable entry frames, a rating of IP54 is achieved (with correct selection of cable inserts). Slide frames which are no longer required, are closed with BPK-SNAP blind plates.

Advantages and Notes

- Easy assembly and removal
- During assembly, almost the complete base of the enclosure can be used for installation of cables
- Even large connectors can be installed easily
- The base plate KDR-ESR is designed for Rittal enclosures TS8. Other sizes can be supplied on request
- No additional sheet metal work required
- Retrofitting possible without disconnecting cables. Everything can be built around the cables

Specifications

Material	Base plate: Carbon steel, zinc-plated KDR-ESR Frame: Polyamide (PA)
Flame class	UL94-Vo, self-extinguishing
Protection class	IP54, with gasket and correct selection of the cable inserts
Temperature Properties	- 40°C to + 90°C (static) Halogen free, silicone free

Fits with

KEL(-ER) 16 / 24 Cable entry frames	Page 6-9
KEL-JUMBO Cable entry frames	Page 40
BPK-SNAP 16 / 24 Blind plates	Page 142

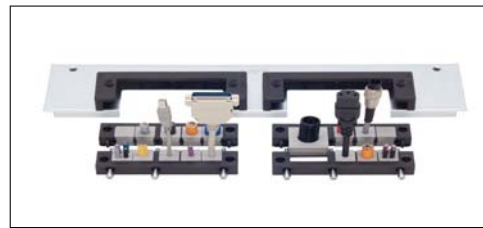

1

The base plate is fixed in the enclosure base. The KEL cable entry frames are fitted.

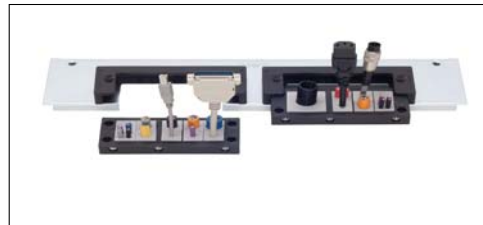

2

The KEL cable entry frames are screwed together after fitting.

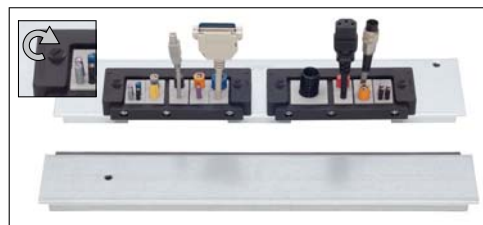

3

Afterwards the KEL frames are pushed into the Slide frames and fixed with the knurled screws.



4

Finally, the middle base plate which is part of the standard enclosure, moves together with the KDR-ESR plates.

IP54



RoHS
compliant

Made in
Germany

KDR-ESR

Enclosure Base Plate with Slide Frames

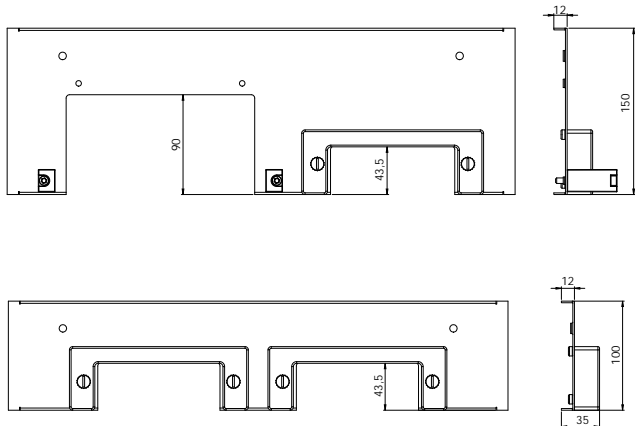

Enclosure type	Enclosure width	Total length base plate	Sight size of base plate opening	No. of possible cable entries				Order No.
				JUMBO 1	JUMBO 2	KEL(-ER) 16 ...	KEL(-ER) 24 ...	
TS8	600 mm	458 mm	436 mm	-	-	-	2	43079
	600 mm	458 mm	436 mm	-	1	-	1	43070
	600 mm	458 mm	436 mm	1	-	2	-	43071
TS8	800 mm	658 mm	636 mm	-	-	1	3	43080
	800 mm	658 mm	636 mm	1	-	-	3	43072
	800 mm	658 mm	636 mm	-	1	-	2	43073
TS8	1000 mm without division bar	858 mm	836 mm	-	-	-	5	43081
	1000 mm without division bar	858 mm	836 mm	1	-	-	4	43074
	1000 mm without division bar	858 mm	836 mm	-	1	-	3	43075
TS8	1000 mm with division bar	420 mm	398 mm	-	-	-	2	43082
	1000 mm with division bar	420 mm	398 mm	1	-	-	1	43076
	1000 mm with division bar	420 mm	398 mm	-	1	-	1	43077
TS8	1200 mm*	518 mm	496 mm	-	-	-	3	43083
	1200 mm*	518 mm	496 mm	1	-	-	2	43078
	1200 mm*	518 mm	496 mm	-	1	-	1	43084

* in case both fields of the enclosure are equipped, 2 complete base plates are necessary.